

Wendi's Vanity



Materials:

- 1-1/4" pocket hole screws
- 2-1/2" pocket hole screws
- 2-1/2" screws
- 3 – Half furniture legs
- Wood glue
- Sandpaper (100, 150, 220 grits)
- Finishing supplies (primer & paint, or stain, sealer)

Lumber:

- 1 – 2x2 at 4'
- 4 – 2x2 at 8'
- 10 – 2x4 at 8'
- 4 – 2x8 at 8'

Cut List:

- 6 – 2x8 (ripped to 3-1/2" wide) at 33" – Legs
- 2 – 2x8 (ripped to 3-1/2" wide) at 16-1/4" – Side Frames
- 10 – 2x2 at 16-1/4" – Side Frames & Slat Supports
- 8 – 2x2 at 23-3/4" – Slat Stretchers
- 4 – 2x8 (ripped to 3-1/2" wide) at 23-3/4" – Upper Stretchers
- 3 – 2x4 at 16-1/4" – Upper Supports
- 10 – 2x4 at 58" – Slats

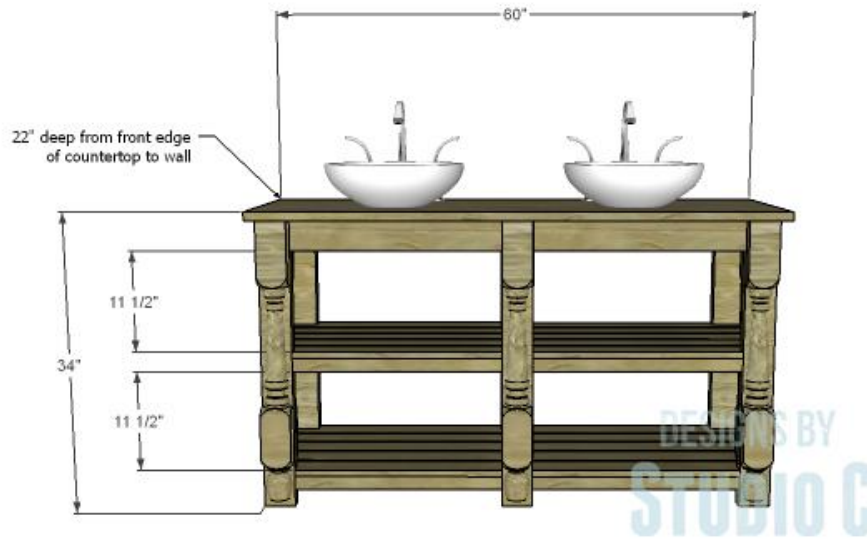

Notes:

The legs, upper side frame pieces, and upper stretchers are cut from a 2x8 ripped to 3-1/2" wide to give them nice, square edges. (2x4s normally have rounded edges and look funny when joined together!) The upper supports and slats can have the rounded edges from the 2x4s...

Step One

Cut the pieces for the legs and the side frame pieces. With the pocket hole jig set for 1-1/2" material, drill pocket holes in each end of the frame pieces. Secure to the legs as shown using glue and 2-1/2" pocket hole screws. The outside face of the frame pieces will be flush with the outside edge of the legs.

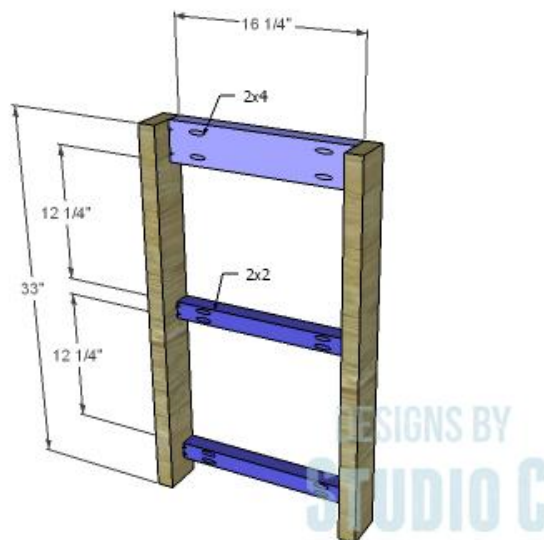

Step Two

Cut the pieces for the slat stretchers and drill pocket holes in each end. Secure to the legs using glue and 2-1/2" pocket hole screws.

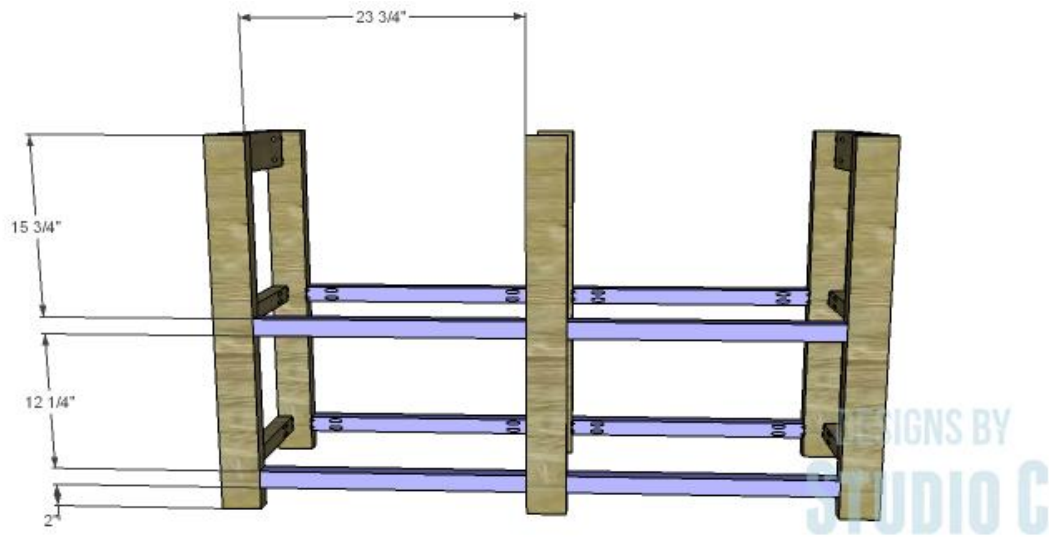

Step Three

Cut the pieces for the slat supports and drill pocket holes in each end. Secure to the slat stretchers using glue and 2-1/2" pocket hole screws.

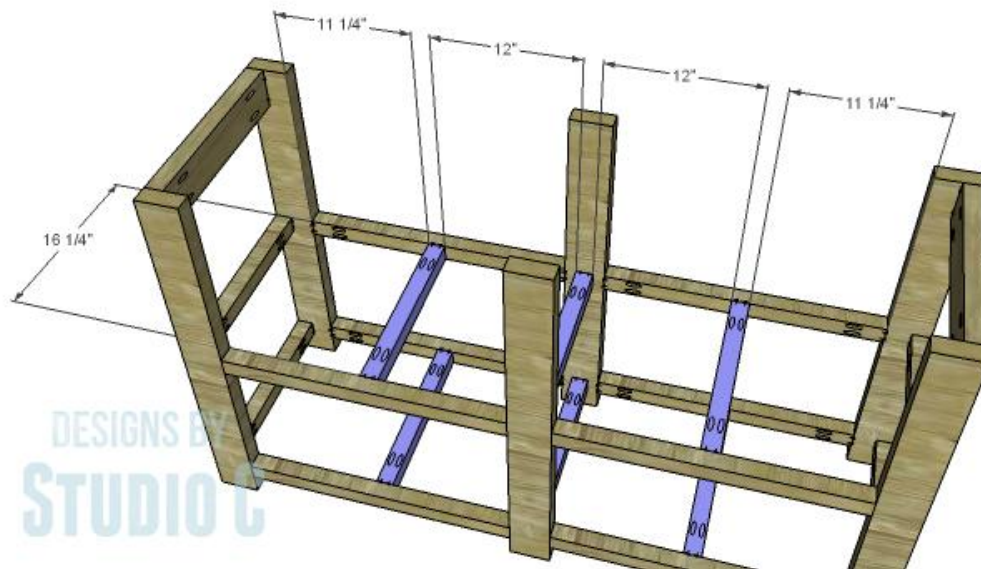

Step Four

Cut the pieces for the upper stretchers and drill pocket holes in each end. Secure to the legs using glue and 2-1/2" pocket hole screws. The pocket holes in the back pieces can face to the wall so they won't be seen!

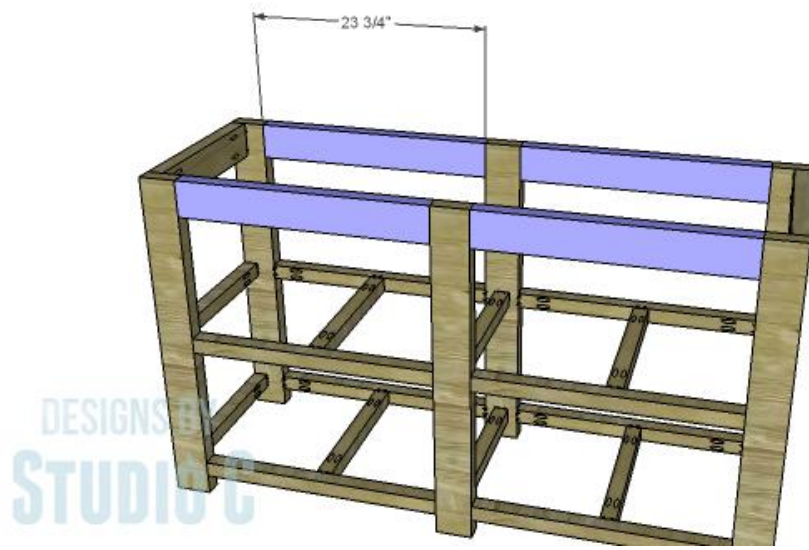

Step Five

Cut the pieces for the upper supports and drill pocket holes in each end. Secure to the upper stretchers using glue and 2-1/2" pocket hole screws.

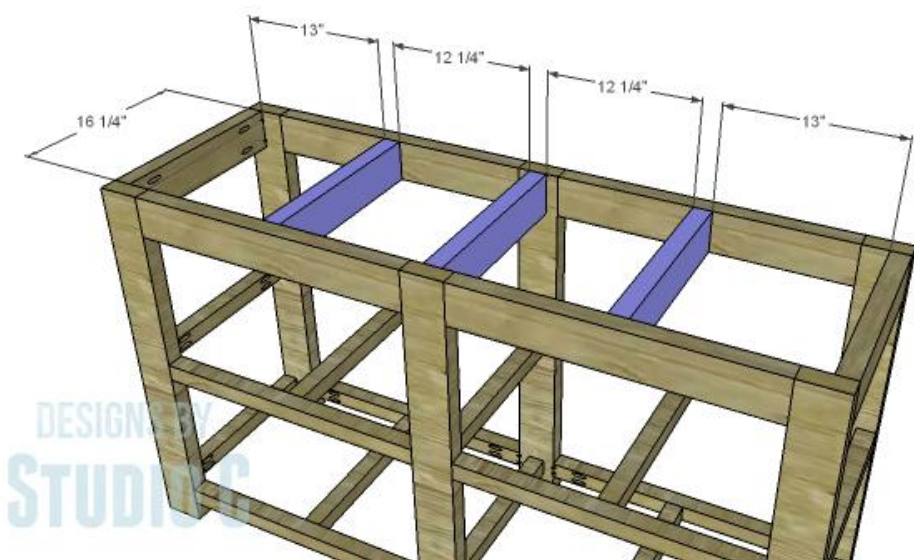

Step Six

Cut the pieces for the slats. Cut the notches in four of the pieces using a jigsaw, and position these pieces in place first securing them with glue and countersunk 2-1/2" screws, starting with the bottom shelf (it will be easier!). Space the remaining slats approximately 1/2" apart, securing in place with glue and countersunk 2-1/2" screws.

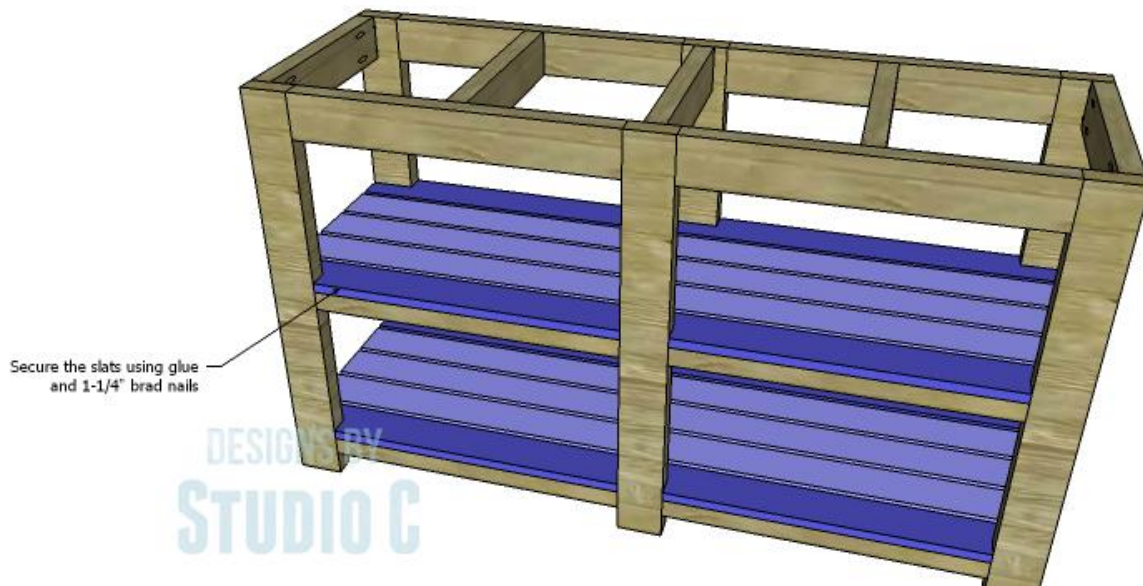
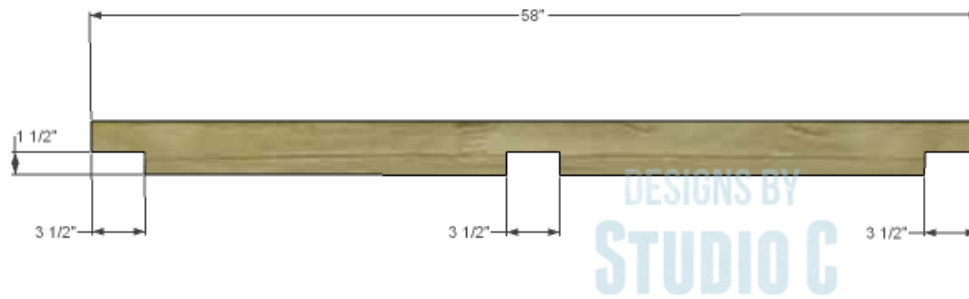

Step Seven

The length of the half furniture legs may have to be adjusted to make them fit. They can be cut down on a miter saw or with a jigsaw. Position the legs on the front legs of the vanity and secure in place with glue and 2-1/2" screws from the back side.

Attach half table legs using glue and countersunk 2-1/2" screws from the back

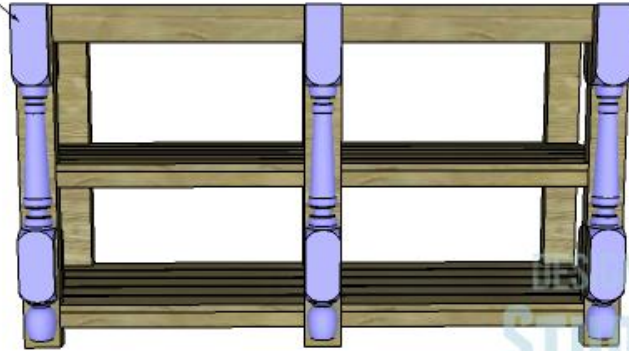

DESIGNS BY
STUDIO C

Finish as desired!

This plan was created expressly for Wendi Wachtel at [H2O Bungalow](#). It is not to be sold or part of any sort of compilation whether electronically or in print, nor is it to be mass-produced, part of a kit, or used commercially without the express written consent of Cher-Ann Texter or Wendi Wachtel. Any violations can be reported here: cher@designsbystudioc.com